

# SWOP B4 PRO & P3 PRO

## Instruction Manual

Beauty Bed | Podiatry Bed

SWOPB4.4.Axx.PRO.V2 | SWOPP3.3.Axx.PRO.V2



SCAN HERE  
to read the  
manual in  
other  
languages



VERSION 1.2025

## Instruction Manual

Beauty Bed | Podiatry Bed

### Table of contents

- ♥ 1. Introduction
- 📖 2. Use of the manual
- 🏆 3. Warranty
- 👥 4. Product Liability
- 👉 5. EC Declaration of conformity
- ⚠️ 6. Safety instructions
- 📐 7. Product Dimensions
- 👤 8. Features & Operation
  - Wheels
  - Levelling feet
  - Breather hole and plug
  - Hand controller
  - Foot controller
  - Paper roll holder
  - Extensible parts
  - Arm rests
  - Interchangeable front panels
  - LED lighting & Cromo Mood
  - Bamboo sound system
- 🔧 9. Maintenance and cleaning
- ✖ 10. Troubleshooting
- 🔧 11. Service
- 🏠 12. EMC Guidance



## 1. Introduction

CONGRATULATIONS! You took NAGGURA home!

Thank you for having acquired a NAGGURA product and for the trust shown in us.

We are sure that this bed will turn into the pillar of your work and will more than fulfil your most demanding work requirements.

NAGGURA's experts are in the lead of a project created with great devotion. Every single detail has been cared to join technology, performance and design altogether in a single table. Our aim is designing and manufacturing INTUITIVE, DYNAMIC and HIGH-TECH tables of a DARING and UNIQUE design.

Thanks for your choice and start enjoying the NAGGURA experience.

 naggura'



## 2. Use of the Manual

Before using the bed, please read the instruction manual carefully. It is important to keep this manual and store it in a safe place so that it can be consulted at any time.

By carefully following these instructions you will be able to avoid any problems in using the treatment table.

Some texts and/or illustrations may not belong to your Naggura bed since they are general and it depends on your product choice at the purchase time.



## 3. Warranty

The warranty period is effective on the date of purchase of the treatment table for a period of two (2) years. It covers all the components of the bed under the normal and correct use. It also covers defects in workmanship from factory.

The above-mentioned warranty does not cover defects or malfunction caused by:

- Misuse, abuse or improper maintenance of the bed and its upholstery;
- Non-observance of the precautions and warnings stated in this instruction manual;
- Lack of maintenance and maintenance or repair tasks carried out by non-qualified service personnel who are unauthorized by the manufacturer;
- Wrong and faulty electrical installations or which do not fulfil the legal requirements;
- Naggura company is not liable for incidental or consequential damage to property or business.



## 4. Product Liability

Under any circumstances, the producer shall be liable for any indirect, special, incidental or consequential damage incurred by the user, the patient or the bed itself as a result of:

- a. A wrong diagnosis;
- b. Incorrect use of the bed or any of its accessories;
- c. The wrong interpretation or non-observance of this user manual;
- d. A lack of maintenance of the bed;
- e. Or maintenance works of the bed and/or repairs performed by persons unauthorized to do so by the manufacturer.

According to the current legislation, the manufacturer cannot be held responsible for any flaws in the table or its components and accessories after a period of ten (10) years from the date on which the producer puts into circulation the actual product. Therefore, producer cannot be obliged to supply any spare parts or accessories for this bed.

## Expected lifespan

Provided that the operator and user takes care of the table and undertakes regular maintenance tasks as described in section 9 of the current manual, the estimated lifespan of the Naggura bed is 10 years from production date.

The intended use of the beauty bed is to position a patient for the treatment. The unit is intended for use by qualified professional within a professional setting.



## 5. EC Declaration of conformity

Naggura products are produced and marked in conformity with the directives hereby stated :

Low voltage : 2014/35/CE

Electromagnetic compatibility : 2014/30/CE



These products are manufactured according to the essential requirements established in the European Medical Devices Directive (Annex II+III of Regulation (EU) 2017/745):

EN ISO 14971:2019; EN ISO 204117:2021; EN ISO 15223-1:2016; ISO 10993-1: 2018; EN ISO 10993-5:2009; EN ISO 109933-10:2013; EN 60601-2-52:2010+AC:2011+A1:2015; EN 60601-1-2:2015+A1:2020; EN 60601-1:2006+A1:2013+AC:2014+A12:2014+A2:2020.

The Swop line has a guarantee of two (2) years in all parts. The manufacturer will not be held responsible for the results of maintenance or repairs performed by unauthorised persons. For further information on guarantee terms, please contact your distributor.



## 6. Safety instructions

### Responsibility of the owner

Naggura beauty and podiatry beds are only meant to be used by professional personnel in beauty, aesthetics, dermatology, podiatry, pedicure and medical aesthetics fields.

It is the responsibility of the owner to ensure that training is given to all operators and third parties (like for example cleaning personnel) on safe use of the treatment table, and that they have read and understood all the operating and safety instructions. Only trained operators may use the treatment bed. Please keep the manual in a place where it is easily accessible to all users, and make it an important part of your employee training program.

### Safety on installation and electricity

- Place the table in a space with free access from the 4 sides. Do not place the table against the wall or against any obstacles.
- Do not use the table in a high-humidity environment
- Check if the mains voltage and frequency are in accordance with the information on the typeshield. If not, contact your supplier before connecting the device.
- Please pay attention that the continuous working times should be "Max. 2min. ON; 18min. OFF" when operating the motor.
- Make sure that the unit is correctly plugged into an earth intake, following the local and national requirements and standards.
- Make sure that the mains cable is positioned in such a way that it cannot get stuck between the mechanism.
- Especially pay attention that the mains cable does not get pinched under the feet of the table, for example after the tables has been moved on its wheels.
- If the table gets wet accidentally, unplug the table immediately.
- Do not leave children unattended near the table.
- Unless being monitored or instructed by personnel who can be responsible for their personal safety, the people who have physical obstacles, tactile disorders, mental disorders, lack of experience, common sense or children, are not allowed to use the equipment.
- Do not use the device near electromagnetic transmitters. Read and follow all the information about electromagnetic compatibility (EMC) in page 19.
- If the power cord or plug is damaged, please contact the distributor, service center or experienced technicians for repairing.



## Safety instructions

### Safety during treatments

- Don't let anybody, except the operator and the patient, in the treatment room.
- The bed is not intended to transport patients. Therefore it cannot be used for this purpose.
- Do not sit on the head section or end of the leg section of the table. The head section and armrests are not suitable to sit on.
- Patients are not to be left unattended.
- Never leave the bed on its wheels during the treatment.
- Do not exceed the maximum load capacity of the table.
- Place the bed on a stable and horizontal surface. Level it if necessary with the levelling feet under the table.
- Ensure that neither the patient nor the operator can get any part of the body or clothes trapped between the moving parts of the mechanism when the table is being raised or lowered.

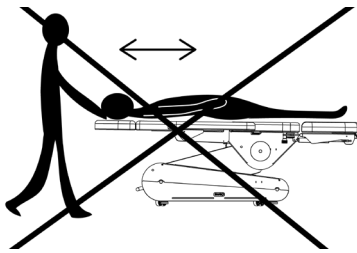

### Safety before or after the treatment

- Do not leave anybody unattended alone near the bed.
- Disconnect the table if not used for a long period of time.

### Safety when cleaning the bed or the therapy room

- Disconnect the table from the power supply.
- Do not get under the bed or between its moving parts.

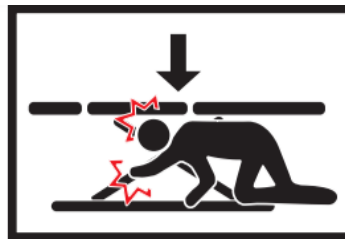

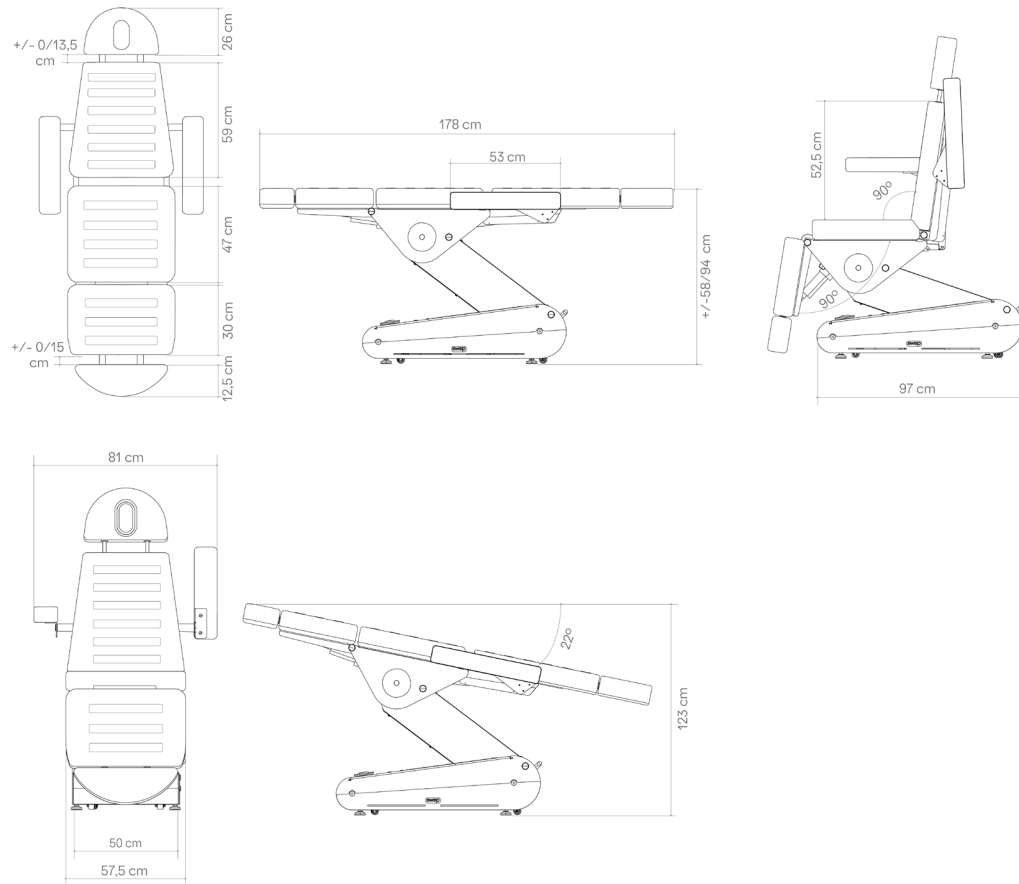
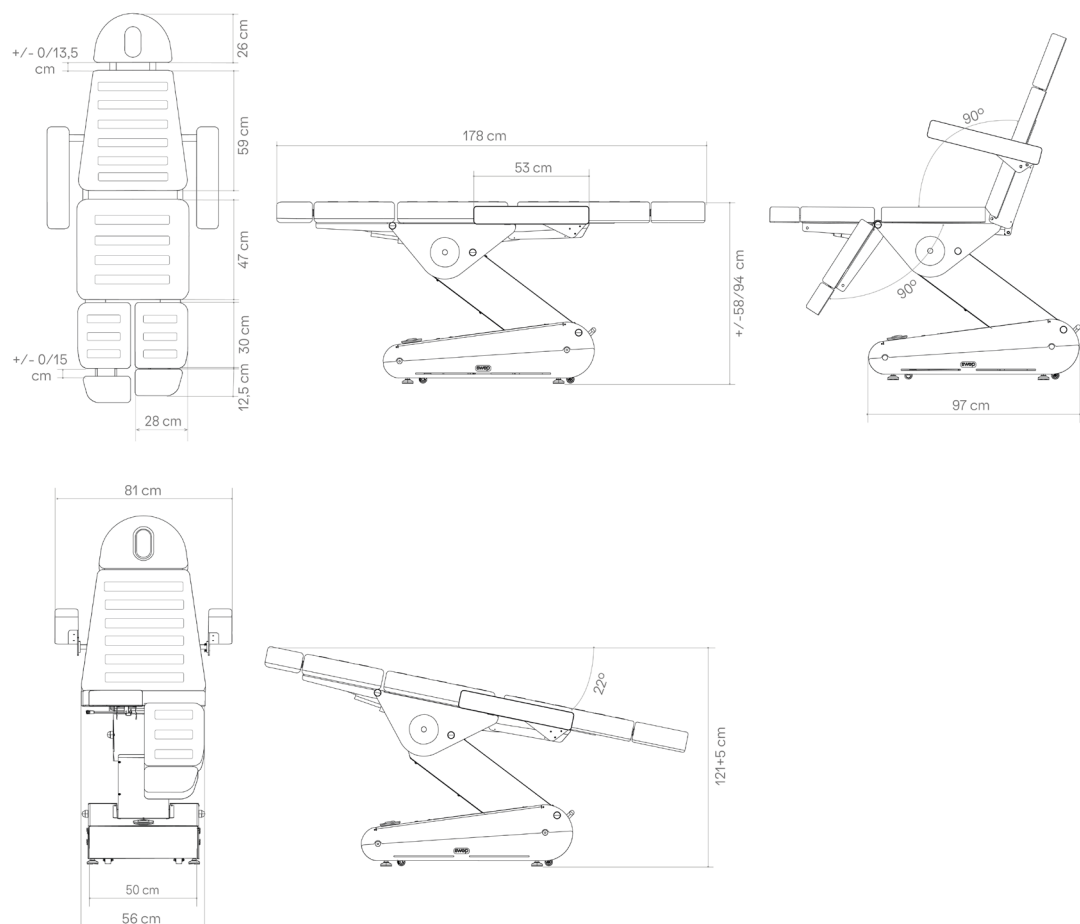

## 7. Product dimensions

Swop B4  
BeautySwop P3  
Podo



Package dimensions (cm)



Handling and transport

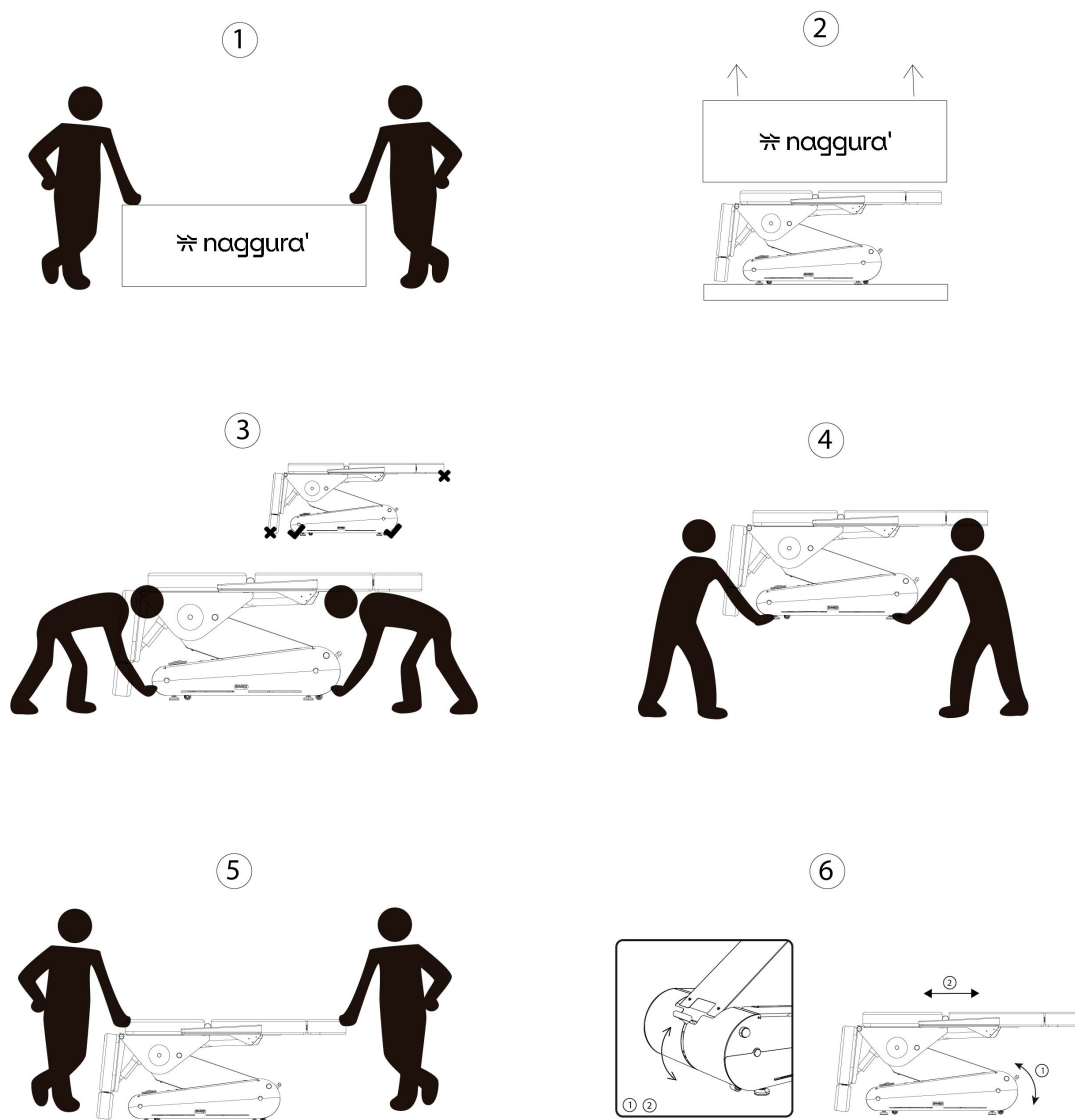





Product dimensions in movement (cm)

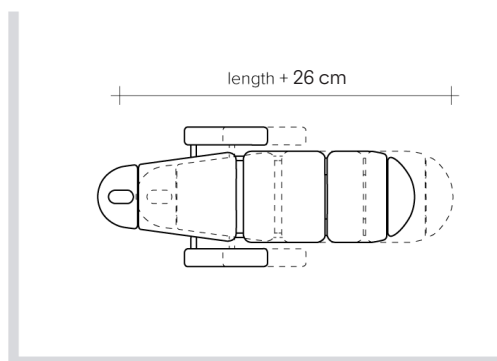

Power cord length (cm)

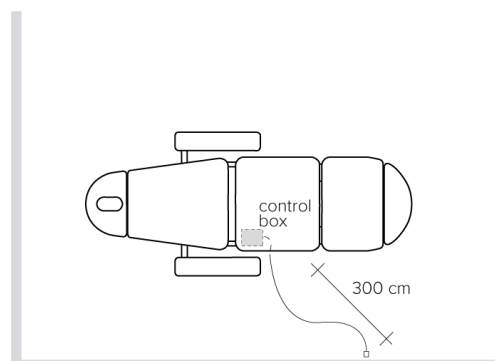

## 8. Operation

### Power input

Voltage and frequency input shall be 100-240V, 50/60Hz. Plug the table cable into the socket as shown below:

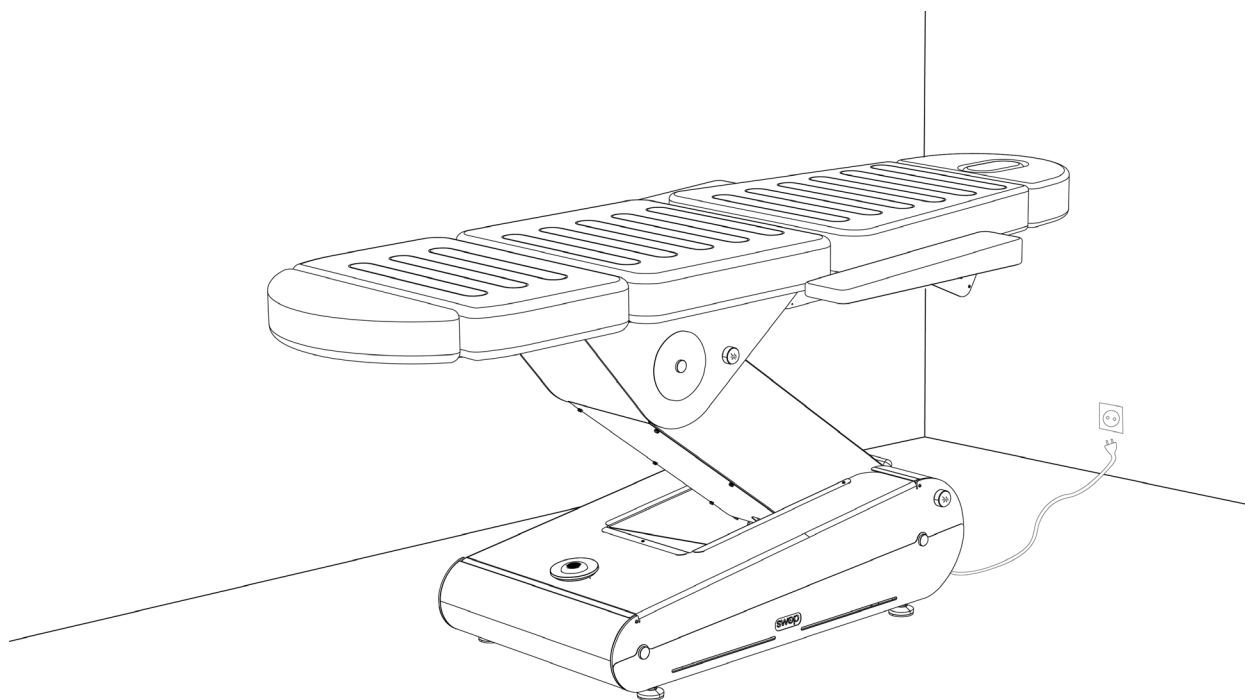



## Operation of Swop B4 Beauty and P3 Podo

1. Levelling feet
2. Lever & wheels
3. Breather hole and plug
4. Hand controller
5. Paper roll holder
6. Extensible parts
7. Arm rests
8. Interchangeable front panels
9. LED lighting / Cromo Mood
10. Bamboo sound system
11. Foot Controller
12. Legs (Swop P3 Podo)

 Optional

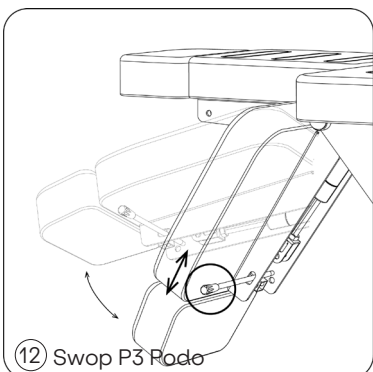
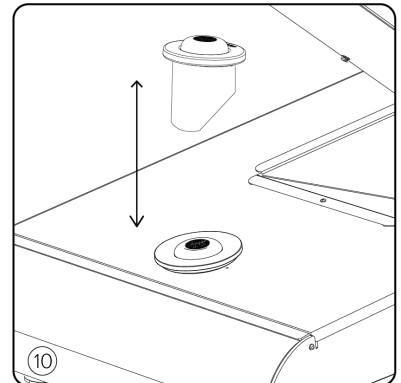
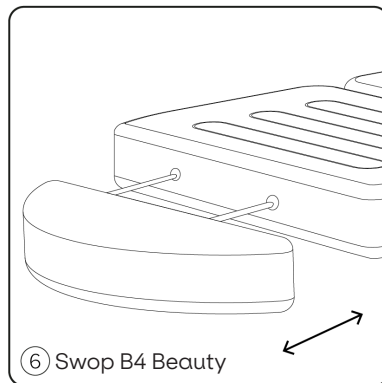
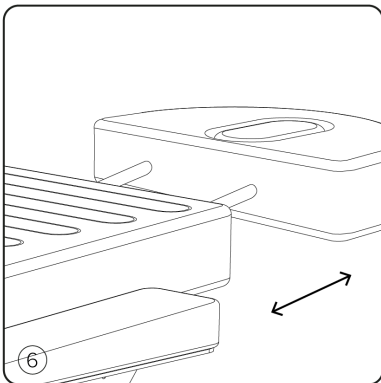
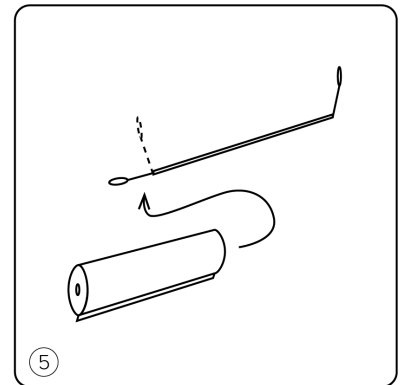
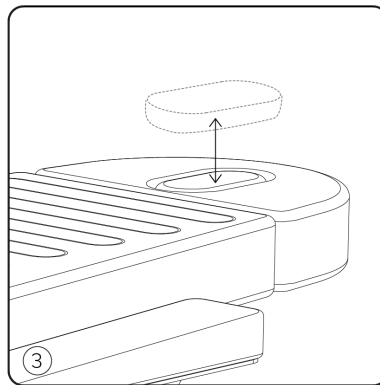
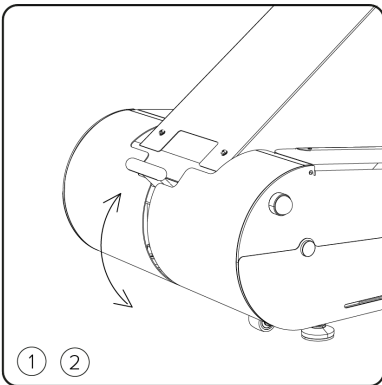
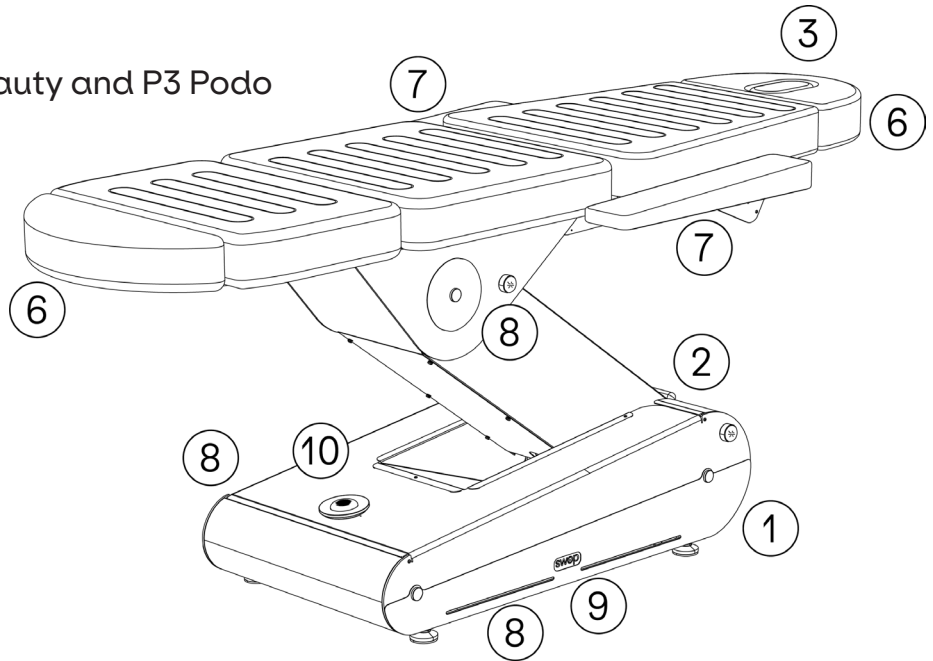



## Operation Swop B4 Beauty

### Hand controller

⑥

The Swop B4 Beauty is equipped with 4 engines.

To lift the bed, simply push the UP button on the hand switch. Once the desired height is achieved, release the button. To lower it, do the same operation with the DOWN button.

You can also adjust the whole inclination of the bed downwards or upwards using the seat inclination keys.

Use the backrest inclination keys to tilt the backrest up and down.

Use the legrest inclination keys to tilt the legrest up and down.

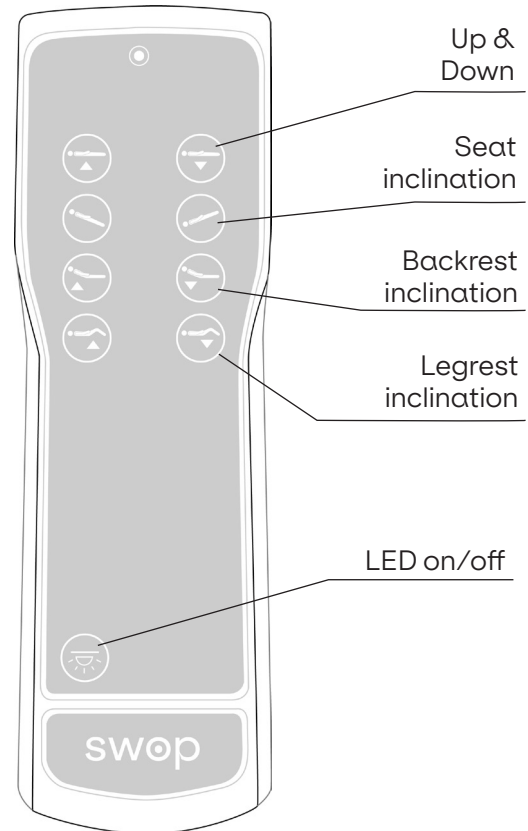

### Foot controller

⑪

A foot controller is available as an option and it can be ordered separately. You can adjust all the 4 movements of the bed by means of the foot controller.

To connect the footcontroller, locate the control box inside the table base frame. Take the safety piece that locks the connectors into each plug. Connect the footcontroller's cable in the correct plug following the instruction image below. Place again the safety piece to lock the connectors.

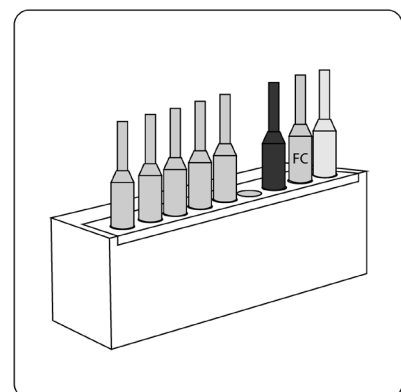
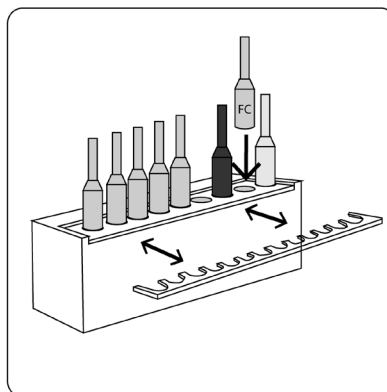
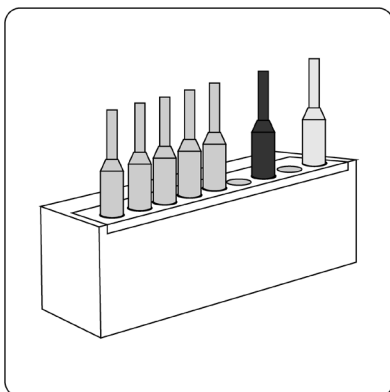
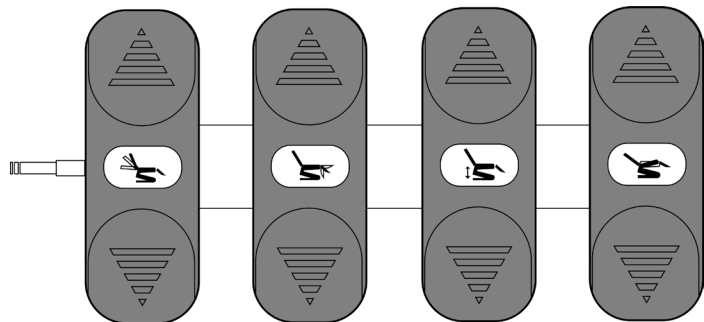



## Operation Swop P3 Podo

### Hand controller ⑥

The Swop P3 Podo is equipped with 3 engines.

To lift the bed, simply push the UP button on the hand switch. Once the desired height is achieved, release the button. To lower it, do the same operation with the DOWN button.

You can also adjust the whole inclination of the bed downwards or upwards using the keys in the second row.

Use the backrest inclination keys to tilt the backrest up and down.

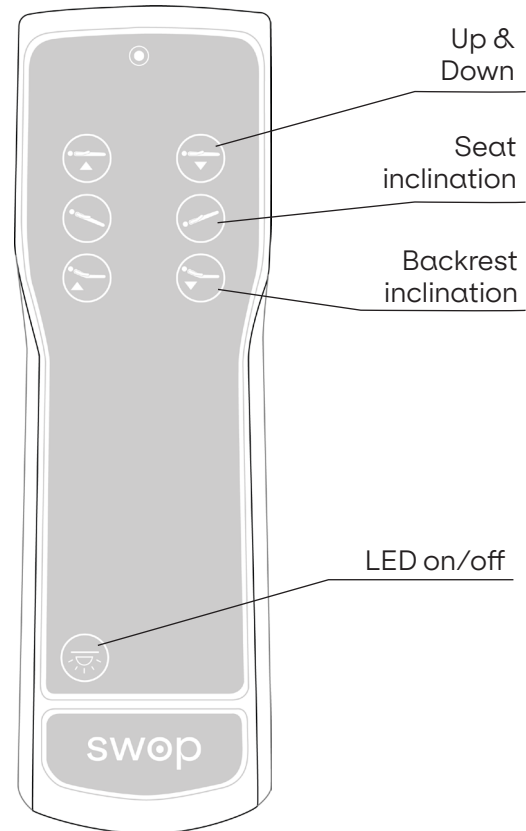

### ⑪ Foot controller

A foot controller is available as an option and it can be ordered separately. You can adjust all the 3 movements of the bed by means of the foot controller.

To connect the footcontroller, locate the control box inside the table base frame. Take the safety piece that locks the connectors into each plug.

Connect the footcontroller's cable in the correct plug following the instruction image below. Place again the safety piece to lock the connectors.

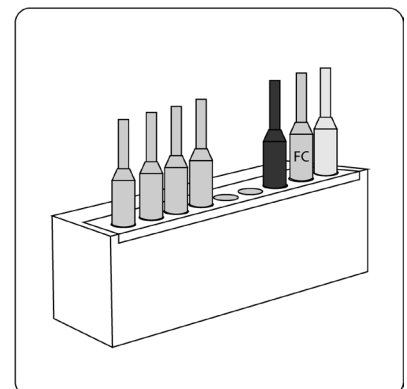
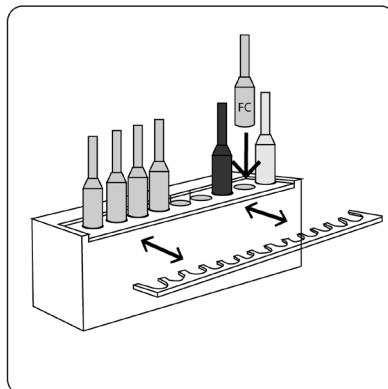
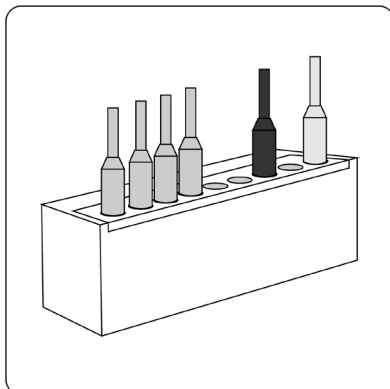
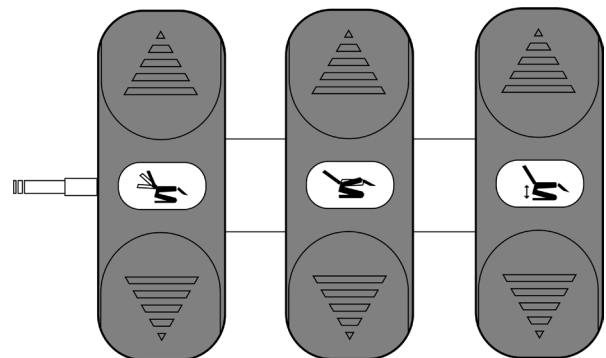



## Operation

### Legs (Swop P3 Podo)

The Swop P3 Podo podiatry bed is equipped with 2 leg rests that can be moved up and down individually to the vertical desired position.

To adjust them use the levers placed at each side of the leg rests to activate the gas lift. They can be placed up to horizontal plane (90°).

Extensible foot rests that can be adjusted according to the height of the patient.

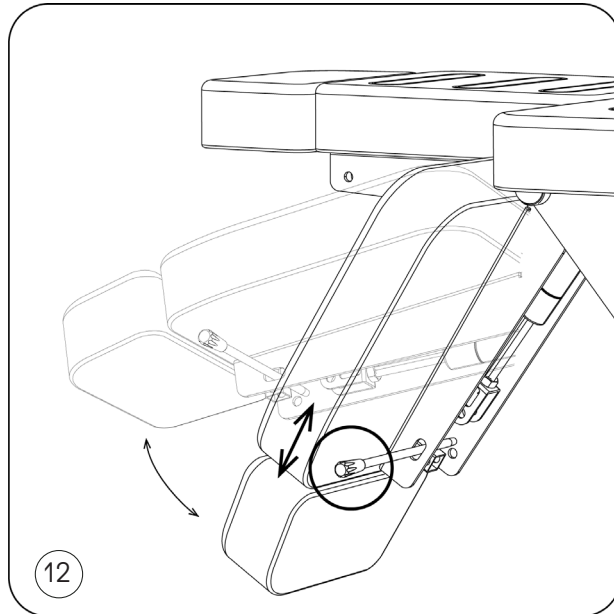

### Paper roll holder

You can optionally add a paper roll holder to both Swop B4 Beauty and Swop P3 Podo.

This roll holder works differently from the physio one, because it's supported by threads on both sides that go hooked to the armrests of the chair.

Please see below how to install it:

- 1- Remove one armrest, place the hook on the union bar and put the armrest back to the chair.
- 2- Put the paper roll on the bar.
- 3- Remove the armrest on the opposite side and carefully hook the other side of the roll holder on the union bar. Put the armrest back to the chair.

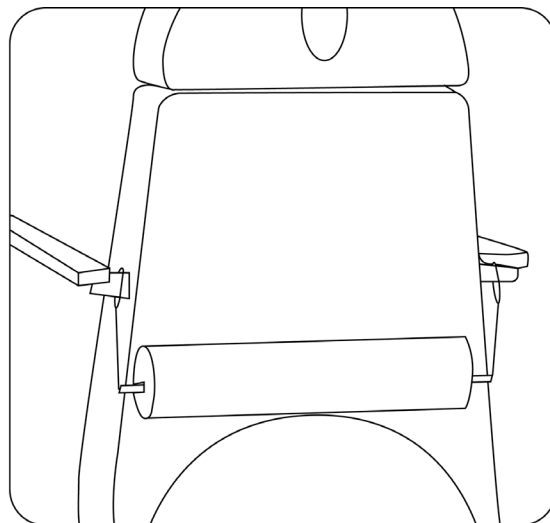
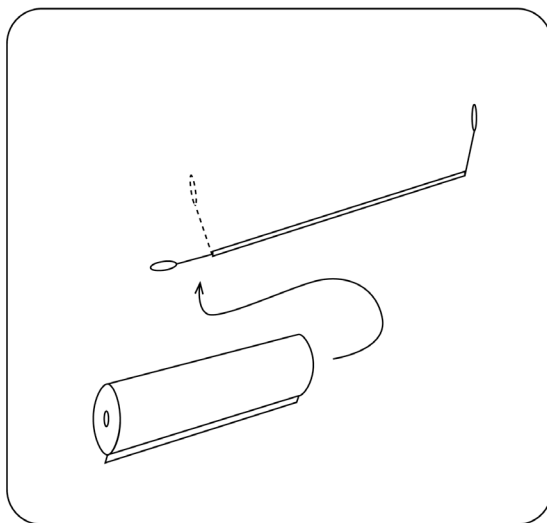



Operation

Specifications

Product size	178 (+/- 26 cm with movement) x 81 x 58 / 94 cm
Package size	127 x 62 x 61 cm
Highest position (flat)	94 cm
Highest position (trendelenburg)	115 cm
Lowest position	58 cm
Net weight	B4: 100 Kg / P3: 103 Kg
Gross weight	B4: 114 Kg / P3: 118 Kg
Power	AC 100 - 240V, 50/60Hz
Max power	350W
Environment temperature	0°C - +40°C
Relative humidity	30% - 90%
Max weight supported	175 Kg



## Operation



### Interchangeable Front Panels

⑧

The Swop bed highlights by a very special feature: the front exchangeable panels. There are lot of different possibilities to dress your bed up. Get a new couch in a matter of seconds and according to your taste, the interior design of your centre, your mood or however you feel today!

The exchangeable panels are made of 4 pieces: one for one side of the bed base and the other for its opposite. Then, two spots matching the lower panels are provided too.

The available panels are made of different materials (metal, wood and pmma) and multiple colours. You can visit our website to discover the full range of possibilities.

Changing the panels and beauty spots is so easy! Simply unscrew the 2 screws that subject the panel with your fingers (no tools required). Remove the current panel to place a different one.

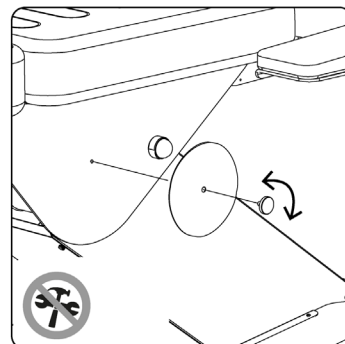
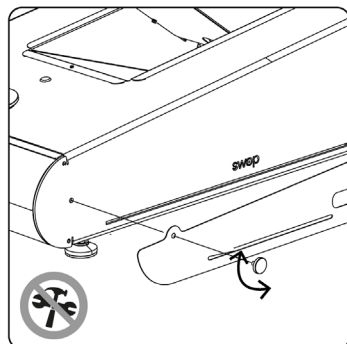
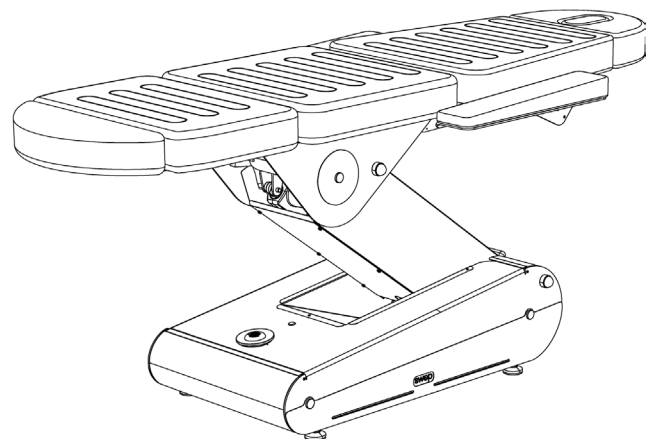
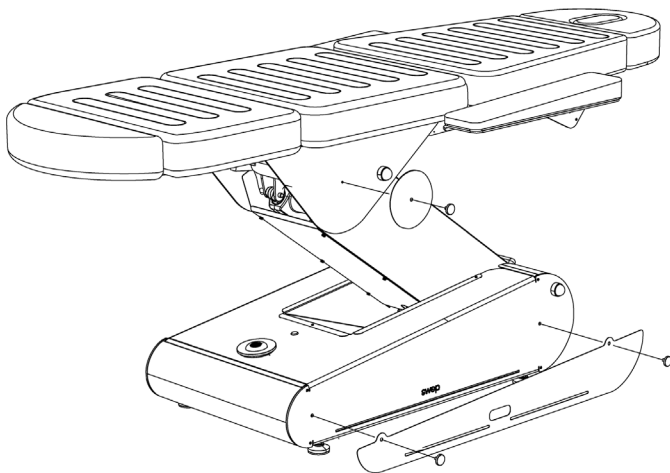



## Operation

### LED lighting / Cromo Mood

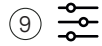

As standard feature placed at both sides of the base, the Swop bed has a white LED lighting. A line that underlines the table and shows the Swop display name. To turn the light on, press the button on top of the hand controller.

As an option the Cromo Mood System with multicolour led lighting can be chosen. This option has to be installed at the purchase time and it cannot be added afterwards.

If the Cromo Mood is installed, an additional hand controller is provided to select your beloved colour, to adjust the intensity of light or to change the lighting mode.

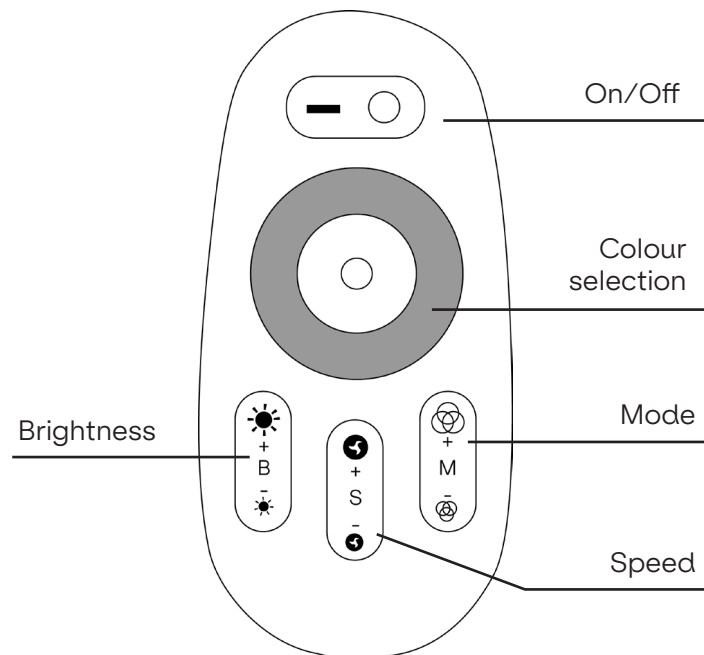
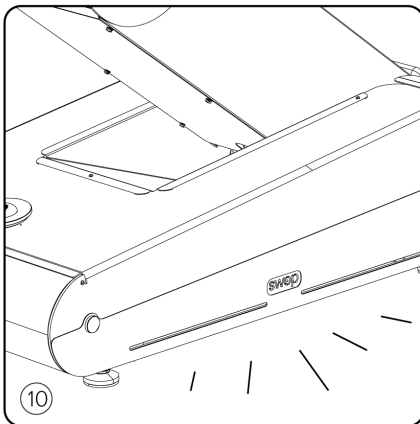

### Bamboo sound system 10

If you purchased the Bamboo sound system, your swop beauty bed arrives with an awesome Bluetooth speaker: we call it the Bamboo sound system.

The speaker is lodged inside a bamboo case with bevelled base. You can place the speaker on the table housing designed for this purpose or take it off and place it on your working table. Thanks to its inclined base you can direct the sound wherever you want to.

The Bluetooth speaker has a USB charger and additional instructions. Please read them carefully.

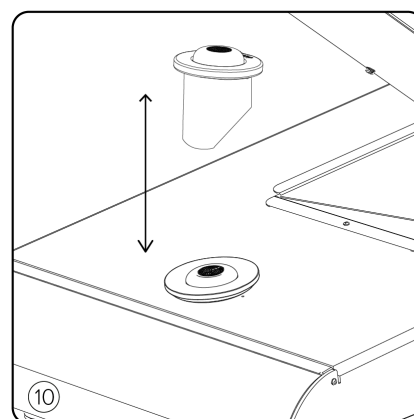
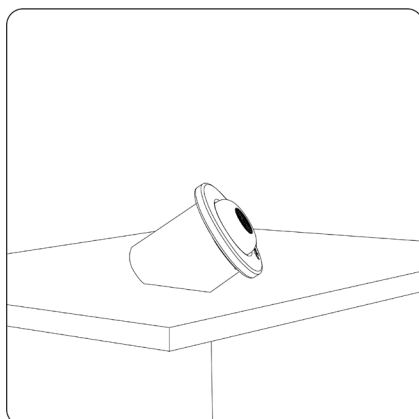





## 9. Maintenance and cleaning

### Upholstery Daily Cleaning

It is very important for the life of the upholstery to clean it properly.

1.- Clean the entire surface using a mixture of 1:9 liquid soap (neutral pH) and water. Do not use soap or cleaning solutions that contain alcohol, ketones, xylene, acetates or solvents (mineral/white spirits).

2.- Completely remove excess cleaner with a white, clean, damp cloth.

3.- Dry the surface.

- **Important:** Lacquers, strong cleaners, xylene-based solutions, acetone or MEK cause immediate damage and contribute to the deterioration of the material. The use of such cleaners is at the owner's risk.

### Table Frame Cleaning

Remove dust with a white cloth.

Use alcohol-free cleaning wipes to clean the structure or simply use a white cotton cloth soaked in a mix of water with neutral diluted soap and rinse. Dry with a clean cloth.

### Maintenance

Naggura tables have been designed for an intensive use during long time thanks to their stability, reliability and durability.

However, we advise to keep the table in perfect conditions and make a correct use of it. Unplug the table if you will not use it for a long period of time.

### Environment information

This symbol indicates that some electrical components or materials can be reused and/or are harmful to the environment and thus, they must be properly recycled. Ensure that you are familiar with the local rules and regulations regarding to the disposal of equipment and accessories.



## 10. Troubleshooting

### Squeaking noise when moving the bed up & down (mechanical noise):

- The axes are adjusted and greased from factory but with the time and use, they may need some little adjustment. Remove the grey plugs of the connecting rods (2 at each side, so 4 in total). Loosen the axes a little bit by unscrewing them (approx. 2 turns). Apply a bit of neutral grease and plug them again.

### None of the motors work:

- Check if the power cable is disconnected, either from the wall socket or the control box.
- Check the power cable for any damage.
- Check all the plugs and connections.
- Check if the LED light in the control box is lightened GREEN.

### If 1 motor is faulty:

- Follow the TEST to determine whether the source of the problem lies in the control box, the hand controller or motor of the affected part. Exchange the cable of the faulty motor with another section that works properly to discard. GET access to the control box. The control box has the connections of the hand controller, the 4 engines of the bed and the power supply cable.

If the motor of the backrest does not work, unplug for example the HEIGHT motor and plug this wire in the BACKREST motor socket (exchange socket from other motor that works fine). Check the movement of the HEIGHT motor by pressing the buttons of the BACKREST movement in the hand controller to observe the motor operation.

- If the motor does not work, the problem is the motor.
- If the motor works properly, the problem would be the control box.

### Persisting problems

If problems persist, please contact your dealer and provide the serial number and model of the table as they appear under the bed.

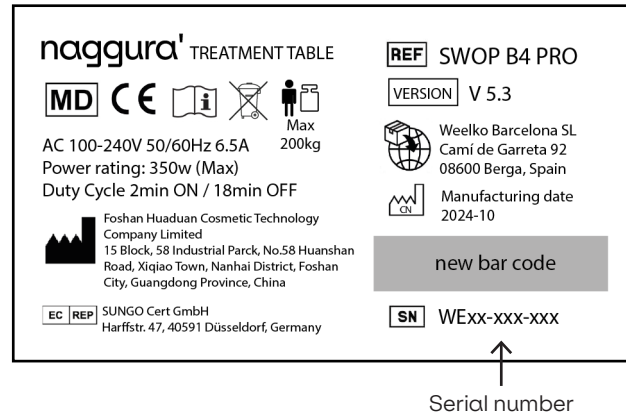

## 11. Service

Only a technician authorised by Naggura is allowed to perform any kind of repairs on the bed.

If your technical staff is allowed by Naggura to repair the bed, Naggura can provide the necessary instructions and spare parts lists.

Please contact your local Naggura distributor for more information.



## 12. EMC Guidance

Guidance and Manufacturer's Declaration - Electromagnetic Emissions	
Emissions test	Compliance
RF emissions CISPR 11	Group 1
RF emissions CISPR 11	Class A
Harmonic emissions IEC 61000-3-2	Class A
Voltage fluctuations/flicker emissions IEC 61000-3-3	Complies

**Warning:** It is not safe to operate the device in the presence of HF surgical equipment or places where the intensity of EM disturbances is high.

**Warning:** Use of this equipment adjacent to or stacked with other equipment should be avoided because it could result in improper operation. If such use is necessary, this device and other equipment should be observed to verify that they are operating normally.

**Warning:** Use only accessories and cables provided by the manufacturer. Accessories and cables not recommended may affect the EM emissions or immunity.

**Warning:** Maintain minimum distance of 12 inches (30 cm) between any part of the working table and portable RF communication equipment (including peripherals such as antenna cables and external antennas.) Performance of the table might degrade if proper distance is not maintained.

Guidance and Manufacturer's Declaration - Electromagnetic Immunity		
Immunity Test	IEC 60601-1-2 Test level	Compliance level
Electrostatic discharge (ESD) IEC 61000-4-2	±8 kV contact ±2 kV, ±4 kV, ±kV, ±15 kV air	±8 kV contact ±2 kV, ±4 kV, ±kV, ±15 kV air
Electrical fast transient /burst IEC 61000-4-4	±2 kV for power supply lines ±1 kV for input/output lines	±2 kV for power supply lines ±1 kV for input/output lines
Surge IEC61000-4-5	±1 kV line(s) to line(s) ±2 kV line(s) to earth	±1 kV line(s) to line(s) ±2 kV line(s) to earth
Voltage dips, short interruptions and voltage variations on power supply input lines IEC 61000-4-11	0% U; 0.5 cycle T at 0°, 45°, 90°, 135°, 180°, 225°, 270°, 315° 0% UT; 1 cycle 70% UT; 25/30 cycle 0% U; 250/300 cycle	0% U; 0.5 cycle T at 0°, 45°, 90°, 135°, 180°, 225°, 270°, 315° 0% UT; 1 cycle 70% UT; 25/30 cycle 0% U; 250/300 cycle
Power frequency (50/60 Hz) Magnetic field IEC61000-4-8	30 A/m 50Hz/60Hz	30 A/m 50Hz/60Hz
Conducted RF IEC61000-4-6	3 V r.m.s. 150 kHz to 80 MHz 6 V RMS in the ISM bands between 0.15 MHz and 80 MHz	3 V r.m.s. 150 kHz to 80 MHz 6 V RMS in the ISM bands between 0.15 MHz and 80 MHz
Radiated RF IEC61000-4-3	3 V/m 80 MHz - 2,7 GHz 80% AM at 1 kHz	3 V/m 80 MHz - 2,7 GHz 80% AM at 1 kHz
NOTE: UT is the a.c. mains voltage prior to application of the test level.		

Test Specifications for enclosure port immunity to RF wireless communications equipment					
Immunity Test	IEC60601 test level				Compliance level
	Test frequency	Modulation	Maximum power	Immunity level	
Radiated RF IEC 61000-4-3	385 MHz	**Pulse Modulation: 18Hz	1.8W	27 V/m	27 V/m
	450 MHz	*FM+ 5Hz derivation: 1kHz sine	2W	28 V/m	28 V/m
	710 MHz 745 MHz 780 MHz	**Pulse Modulation: 217Hz	0.2W	9 V/m	9 V/m
	810 MHz 870 MHz 930 MHz	**Pulse Modulation: 18Hz	2W	28 V/m	28 V/m
	1720 MHz 1845 MHz 1970 MHz	**Pulse Modulation: 217Hz	2W	28 V/m	28 V/m
	2450 MHz	**Pulse Modulation: 217Hz	2W	28 V/m	28 V/m
	5240 MHz 5500 MHz 5785 MHz	**Pulse Modulation: 217Hz	0.2W	9 V/m	9 V/m
<p>Note* - As an alternative to FM modulation, 50% pulse modulation at 18 Hz may be used even if it does not represent actual modulation.</p> <p>Note** - The carrier shall be modulated using a 50% duty cycle square wave signal.</p>					



Our products are subject to continuous technical improvements. Naggura reserves the right to change or modify the product and contents without prior notice.

**naggura'**

Pol. Ind. La Valldan  
Camí de Garreta, 92  
08600 Berga  
Barcelona - Spain  
T. +34 93 824 90 20  
E. [info@naggura.com](mailto:info@naggura.com)